



Regional District of  
**Kitimat-Stikine**

***Evacuation Rescind for New Remo and Parts of Old Remo***

**Flood Update**

The Kalum and Skeena River levels have receded, due to this, Evacuation Orders have been rescinded for New Remo and parts of Old Remo (see Evacuation Rescinds and maps attached). The RDKS is maintaining a **Declaration of Local State of Emergency Order for Area 'C'; an Evacuation Order for Usk until water levels are safe for the Usk Ferry and Cable/Arial car to resume operations; and an Evacuation Order remains for parts of Old Remo** (see revised map attached).

The Evacuation Alert from June 2<sup>nd</sup> remains for Dutch Valley. New Remo and parts of Old Remo are now on Evacuation Alert only. The RDKS continues to monitor all areas.

See Orders at [https://www.rdks.bc.ca/government/news/flooding\\_events\\_2022](https://www.rdks.bc.ca/government/news/flooding_events_2022).

**Emergency Support Services:**

Emergency Support Services (ESS) Reception Centre at the Thornhill Community Center, 3091 Century Street, is **open today, June 8, 2022, from 1:00 p.m. to 5:00 p.m.** or call the ESS contact number 24 hours/7 days a week and leave a message at 250-641-2443.

**If your area's Evacuation Order is rescinded:**

Please return home as soon as possible to secure your property. Security will not be available in alert areas overnight.

At this time residents and businesses in areas which have experienced flooding should consult [Recovering after a flood - Province of British Columbia \(gov.bc.ca\)](https://www2.gov.bc.ca/gov/content/safety/emergency-preparedness-recovery/recovering-after-a-flood)

The Regional District will provide updates, information, and resources on local radio stations, our website [https://www.rdks.bc.ca/government/news/flooding\\_events\\_2022](https://www.rdks.bc.ca/government/news/flooding_events_2022) and social media pages. Our next planned update will be June 9, 2022.

Prepared by/contact: Renee Lukasser  
Section / Title: EOC Information Officer  
Contact: [reneel@rdks.bc.ca](mailto:reneel@rdks.bc.ca)

Approved by EOC Director: \_\_\_\_\_

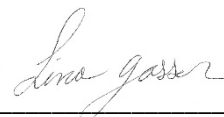
  
Lina Gasser

During Office hours Monday to Friday 8:30 a.m. – 4:30 p.m. 250-615-6100 or toll free 1-800-663-3208  
After hours Provincial Emergency Coordination call number: 1-800-663-3456

## EVACUATION RESCIND New Remo

June 8, 2022 at 14:00 hrs

The Evacuation Order, pursuant to Section 12 (1) of the BC Emergency Program Act issued on June 5, 2022, at 20:00 hrs to the area of New Remo has been rescinded.

### Evacuation Alert remains in effect

An Evacuation Order may need to be reissued; however, if that is deemed necessary, the Evacuation Order process will re-commence.

#### **WHAT YOU SHOULD DO:**

- Return home as soon as possible to secure your property.

Further information is available on the RDKS website  
[https://www.rdks.bc.ca/government/news/flooding\\_events\\_2022](https://www.rdks.bc.ca/government/news/flooding_events_2022)



EOC Director, Regional District of Kitimat-Stikine

The map displays the Skeena River flowing through the center, with Highway 16 running parallel to its right bank. Several large land parcels are labeled with 'L' followed by a number: L 1706 to the west, L 1716 and L 1718 to the north, L 1717 along the riverbank, L 2265 to the southwest, and L 4698 to the east. A 'Rem.' (Remainder) area is shown to the southeast, and 'Blk. A' (Block A) is located further south. The map also shows various smaller parcels, some with red numbers, and roads like 'Robby Road' and 'Highway 16'. The text 'New Remo' is prominently displayed at the top left.

[illegible]

L 1716

1

2

Plan

3

4

5

6

7

8

9

10

11

12

13

14

15

16

17

18

19

20

21

22

23

24

25

26

27

28

29

30

31

32

33

34

35

36

37

38

39

40

41

42

43

44

45

46

47

48

49

50

51

52

53

54

55

56

57

58

59

60

61

62

63

64

65

66

67

68

69

70

71

72

73

74

75

76

77

78

79

80

81

82

83

84

85

86

87

88

89

90

91

92

93

94

95

96

97

98

99

100

101

102

103

104

105

106

107

108

109

110

111

112

113

114

115

116

117

118

119

120

121

122

123

124

125

126

127

128

129

130

131

132

133

134

135

136

137

138

139

140

141

142

143

144

145

146

147

148

149

150

151

152

153

154

155

156

157

158

159

160

161

162

163

164

165

166

167

168

169

170

171

172

173

174

175

176

177

178

179

180

181

182

183

184

185

186

187

188

189

190

191

192

193

194

195

196

197

198

199

200

201

202

203

204

205

206

207

208

209

210

211

212

213

214

215

216

217

218

219

220

221

222

223

224

225

226

227

228

229

230

231

232

233

234

235

236

237

238

239

240

241

242

243

244

245

246

247

248

249

250

251

252

253

254

255

256

257

258

259

260

261

262

263

264

265

266

267

268

269

270

271

272

273

274

275

276

277

278

279

280

281

282

283

284

285

286

287

288

289

290

291

292

293

294

295

296

297

298

299

300

301

302

303

304

305

306

307

308

309

310

311

312

313

314

315

316

317

318

319

320

321

322

323

324

325

326

327

328

329

330

331

332

333

334

335

336

337

338

339

340

341

342

343

344

345

346

347

348

349

350

351

352

353

354

355

356

357

358

359

360

361

362

363

364

365

366

367

368

369

370

371

372

373

374

375

376

377

378

379

380

381

382

383

384

385

386

387

388

389

390

391

392

393

394

395

396

397

398

399

400

401

402

403

404

405

406

407

408

409

410

411

412

413

414

415

416

417

418

419

420

421

422

423

424

425

426

427

428

429

430

431

432

433

434

435

436

437

438

439

440

441

442

443

Bern

L 1706

L 17

Royal Road

Weinmann Road

206 206.6 206.5 206.8

Plan 4181

Rm. 2

Plan 8760

A map of the Skeena River area. The river is labeled "Skeena River" in large, bold, black letters. The map shows several land parcels. One parcel is labeled "L 4898" and "L 2297 L 4898". Another parcel is labeled "L 4898". A third parcel is labeled "L 4898". A fourth parcel is labeled "L 4898". A fifth parcel is labeled "L 4898". A sixth parcel is labeled "L 4898". A seventh parcel is labeled "L 4898". A eighth parcel is labeled "L 4898". A ninth parcel is labeled "L 4898". A tenth parcel is labeled "L 4898". A eleventh parcel is labeled "L 4898". A twelfth parcel is labeled "L 4898". A thirteenth parcel is labeled "L 4898". A fourteenth parcel is labeled "L 4898". A fifteenth parcel is labeled "L 4898". A sixteenth parcel is labeled "L 4898". A seventeenth parcel is labeled "L 4898". An eighteenth parcel is labeled "L 4898". A nineteenth parcel is labeled "L 4898". A twentieth parcel is labeled "L 4898". A twenty-first parcel is labeled "L 4898". A twenty-second parcel is labeled "L 4898". A twenty-third parcel is labeled "L 4898". A twenty-fourth parcel is labeled "L 4898". A twenty-fifth parcel is labeled "L 4898". A twenty-sixth parcel is labeled "L 4898". A twenty-seventh parcel is labeled "L 4898". A twenty-eighth parcel is labeled "L 4898". A twenty-ninth parcel is labeled "L 4898". A thirtieth parcel is labeled "L 4898". A thirty-first parcel is labeled "L 4898". A thirty-second parcel is labeled "L 4898". A thirty-third parcel is labeled "L 4898". A thirty-fourth parcel is labeled "L 4898". A thirty-fifth parcel is labeled "L 4898". A thirty-sixth parcel is labeled "L 4898". A thirty-seventh parcel is labeled "L 4898". A thirty-eighth parcel is labeled "L 4898". A thirty-ninth parcel is labeled "L 4898". A fortieth parcel is labeled "L 4898". A forty-first parcel is labeled "L 4898". A forty-second parcel is labeled "L 4898". A forty-third parcel is labeled "L 4898". A forty-fourth parcel is labeled "L 4898". A forty-fifth parcel is labeled "L 4898". A forty-sixth parcel is labeled "L 4898". A forty-seventh parcel is labeled "L 4898". A forty-eighth parcel is labeled "L 4898". A forty-ninth parcel is labeled "L 4898". A fiftieth parcel is labeled "L 4898". A fifty-first parcel is labeled "L 4898". A fifty-second parcel is labeled "L 4898". A fifty-third parcel is labeled "L 4898". A fifty-fourth parcel is labeled "L 4898". A fifty-fifth parcel is labeled "L 4898". A fifty-sixth parcel is labeled "L 4898". A fifty-seventh parcel is labeled "L 4898". A fifty-eighth parcel is labeled "L 4898". A fifty-ninth parcel is labeled "L 4898". A sixtieth parcel is labeled "L 4898". A sixty-first parcel is labeled "L 4898". A sixty-second parcel is labeled "L 4898". A sixty-third parcel is labeled "L 4898". A sixty-fourth parcel is labeled "L 4898". A sixty-fifth parcel is labeled "L 4898". A sixty-sixth parcel is labeled "L 4898". A sixty-seventh parcel is labeled "L 4898". A sixty-eighth parcel is labeled "L 4898". A sixty-ninth parcel is labeled "L 4898". A seventieth parcel is labeled "L 4898". A seventy-first parcel is labeled "L 4898". A seventy-second parcel is labeled "L 4898". A seventy-third parcel is labeled "L 4898". A seventy-fourth parcel is labeled "L 4898". A seventy-fifth parcel is labeled "L 4898". A seventy-sixth parcel is labeled "L 4898". A seventy-seventh parcel is labeled "L 4898". A seventy-eighth parcel is labeled "L 4898". A seventy-ninth parcel is labeled "L 4898". An eightieth parcel is labeled "L 4898". An eighty-first parcel is labeled "L 4898". An eighty-second parcel is labeled "L 4898". An eighty-third parcel is labeled "L 4898". An eighty-fourth parcel is labeled "L 4898". An eighty-fifth parcel is labeled "L 4898". An eighty-sixth parcel is labeled "L 4898". An eighty-seventh parcel is labeled "L 4898". An eighty-eighth parcel is labeled "L 4898". An eighty-ninth parcel is labeled "L 4898". A ninetieth parcel is labeled "L 4898". A ninety-first parcel is labeled "L 4898". A ninety-second parcel is labeled "L 4898". A ninety-third parcel is labeled "L 4898". A ninety-fourth parcel is labeled "L 4898". A ninety-fifth parcel is labeled "L 4898". A ninety-sixth parcel is labeled "L 4898". A ninety-seventh parcel is labeled "L 4898". A ninety-eighth parcel is labeled "L 4898". A ninety-ninth parcel is labeled "L 4898". A hundredth parcel is labeled "L 4898".

Rem.

Blk. A

Except A Strip of Land  
Being the most Southerly 33 Feet  
in Parellel Width Thereof

Rem.

Blk. A

Except A Strip of Land  
Being the most Southerly 33 Feet  
in Parellel Width Thereof

Rem.

Blk. A

Except A Strip of Land  
Being the most Southerly 33 Feet  
in Parellel Width Thereof



Regional District of  
**Kitimat-Stikine**  
Suite 300 - 4545 Lazelle Avenue  
Terrace, B.C. V8G 4E1

**EVACUATION RESCIND**  
**Old Remo – from the intersection of**  
**Whitebottom Road South to the intersection**  
**of Robin Road and Old Remo Rd.**

June 8, 2022 14:00 hrs

The Evacuation Order, pursuant to Section 12 (1) of the BC *Emergency Program Act* issued at June 5, 2022 20:00 hrs to the area(s) **Old Remo – from the intersection of Whitebottom Road South to the intersection of Robin Road and Old Remo Rd.** has been rescinded. Map attached.

**an Evacuation Alert remains in effect**

An Evacuation Order may need to be reissued; however, if that is deemed necessary, the Evacuation Order process will re-commence.

**WHAT YOU SHOULD DO:**

- Return home as soon as possible to secure your property.

Further information is available on the RDKS website  
[https://www.rdks.bc.ca/government/news/flooding\\_events\\_2022](https://www.rdks.bc.ca/government/news/flooding_events_2022)

A handwritten signature in cursive script, reading "Lina Gasser".

---

Lina Gasser, EOC Director

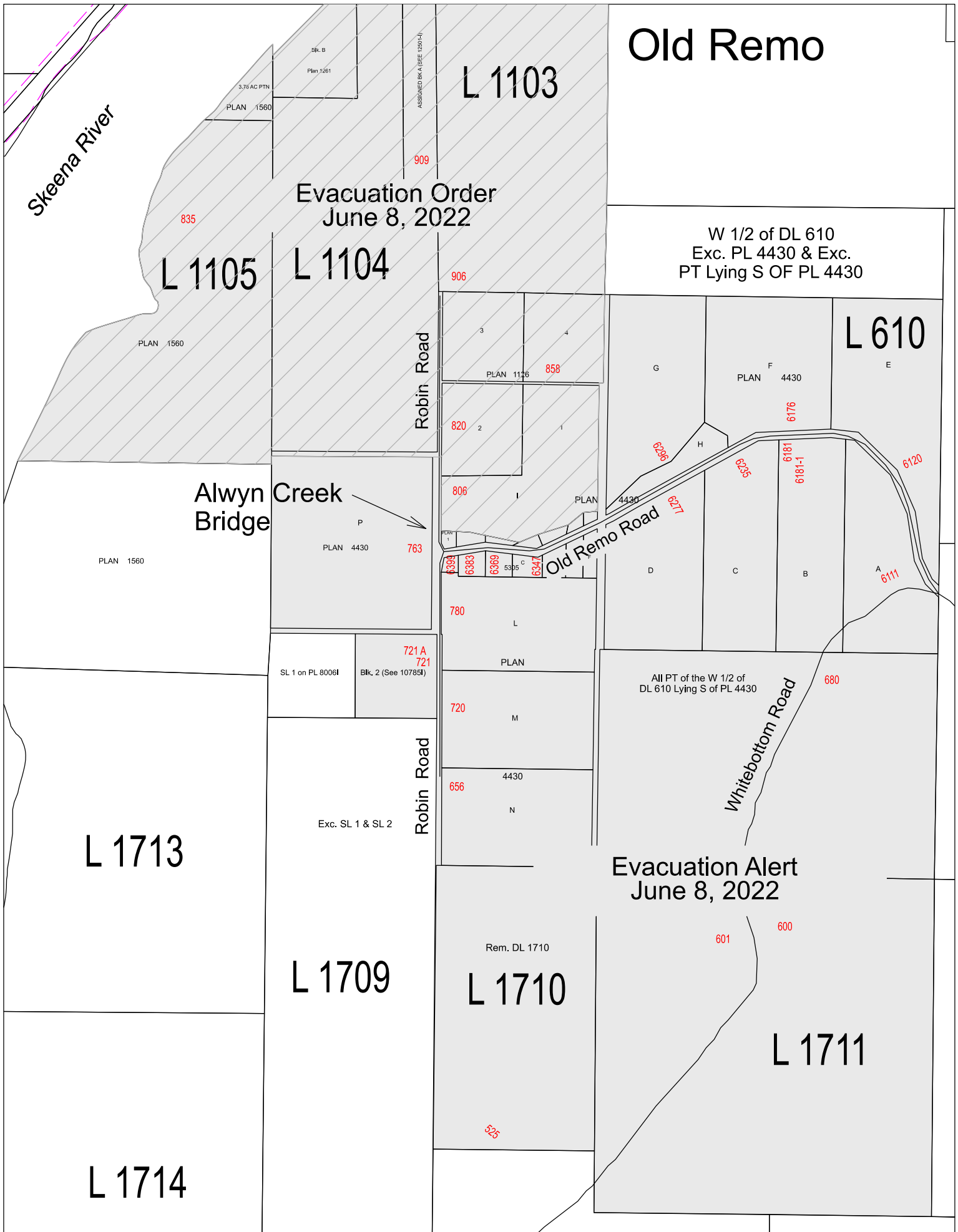

# Old Remo

REVISED

Evacuation Order Boundary: Old Remo  
June 8, 2022

